

MIDLINE JOYSTICK MOUNTING SYSTEM
WITH PC010 RAIL MOUNTING
MODULAR CLAMP

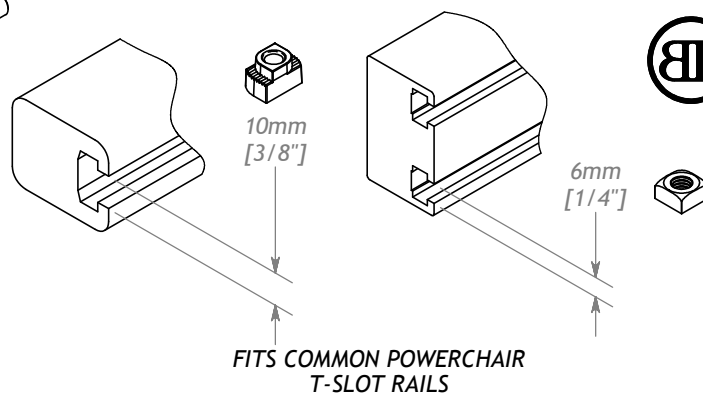

Bodypoint®
technical bulletin

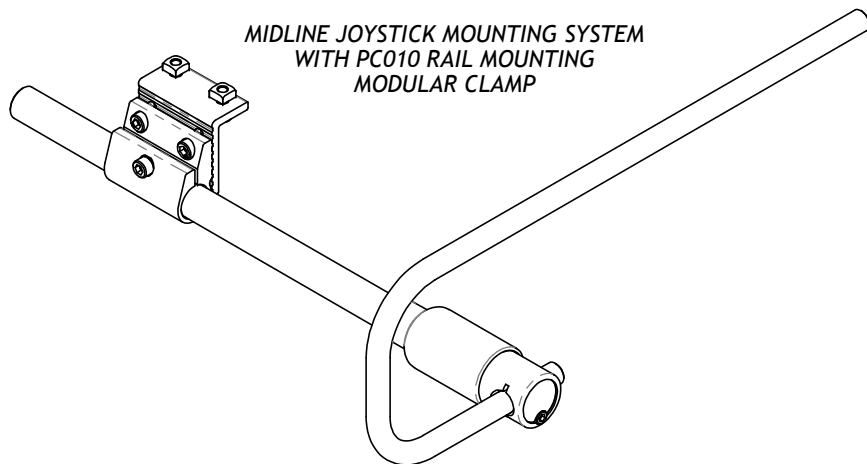
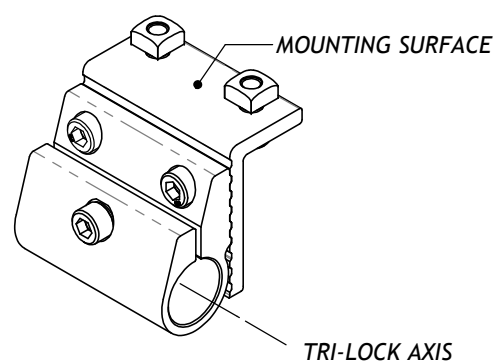

HIGH POSITION

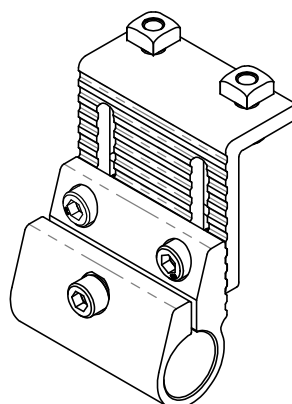

LOW POSITION

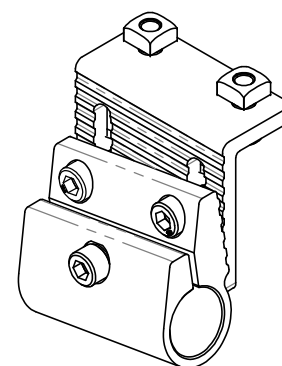
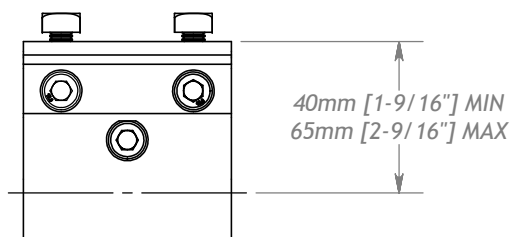

ANGLED POSITION

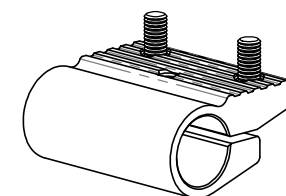
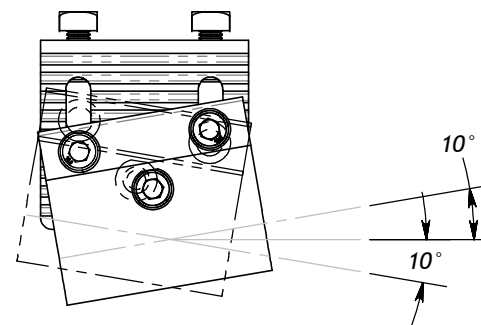

DIRECT MOUNT

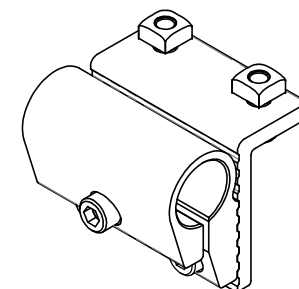

INVERTED POSITION

note

description

TRI-LOCK MODULAR CLAMPS

drawing no.

D15-1001-30

date originated

10/1/2015

drawn by

D. HAGAN

rev.

A



Bodypoint®

technical bulletin

MIDLINE JOYSTICK MOUNTING SYSTEM WITH PC011 TUBE MOUNTING MODULAR CLAMP

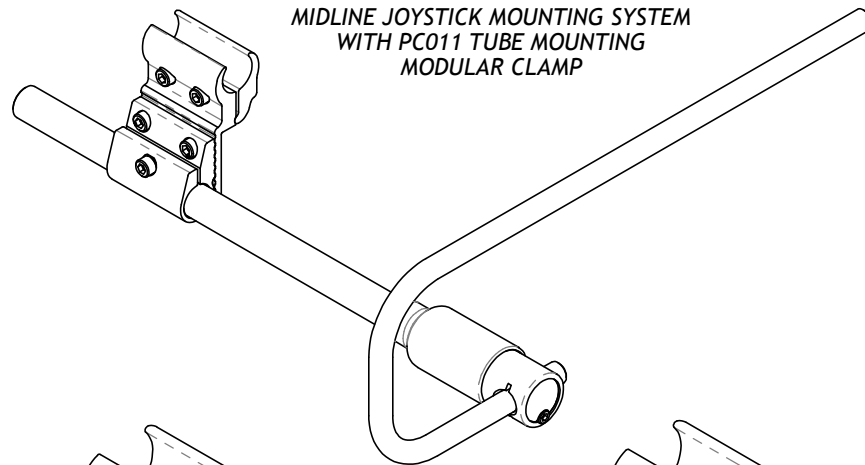

FITS ROUND TUBES

Ø 22mm
[7/8"]

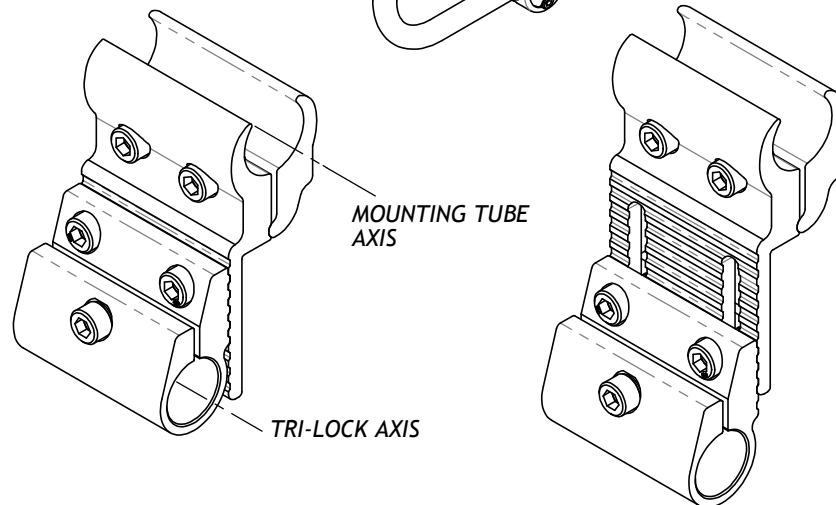

HIGH POSITION

LOW POSITION

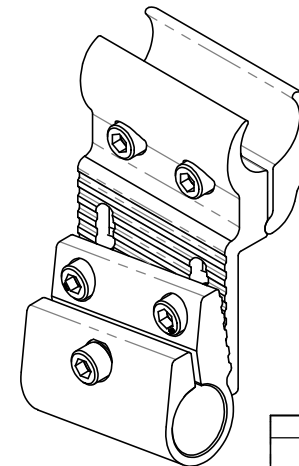
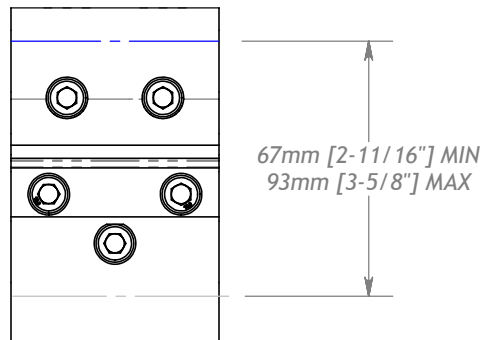

ANGLED POSITION

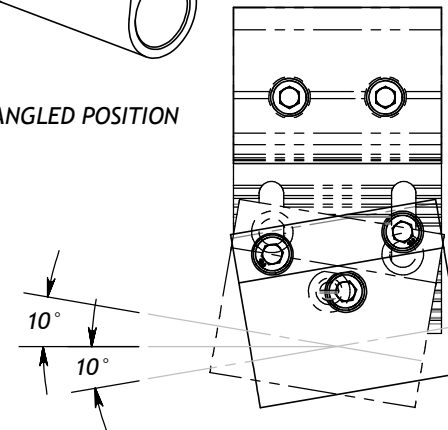

INVERTED POSITION

description

TRI-LOCK MODULAR CLAMPS

drawing no.

D15-1001-30

date originated

10/1/2015

drawn by

D. HAGAN

rev.

A